



SCAN HERE

Installation Videos

Loading Videos

Download Guides

1

INSTALLATION & OPERATIONS MANUAL

MODEL O – Wall Mounted Dispenser

SKU: AF-DISP-OWMS-1 / Model #: AFL 00120



Copyright Aunt Flow 2022 - Patent Pending Dispenser + Product, ALL RIGHTS RESERVED

Questions + Additional Languages: hello@goauntflow.com / 562-320-8250



SCAN HERE

Installation Videos

Loading Videos

Download Guides

PRODUCT OVERVIEW



Dispenser Size

Height	26 inches
Width	14 inches
Depth	6 inches

Dispenser Weight

Empty	22 lbs
Fully Loaded	24 lbs

Package

Height	29 inches
Width	17 inches
Depth	9 inches

Capacity + Product

Aunt Flow® Menstrual Pad Cartridges - 50 pads
 Aunt Flow® Menstrual Applicator Tampons - 50 tampons

Locking

Key Lock

LEGAL THINGS:

(The do's and don'ts of dispensers, which are all very obvious, but should be stated)

- Never hang or pull on the dispenser. The dispenser is not designed to support additional weight.
- The dispenser must be installed properly on a solid surface or structurally adequate wall using appropriate mounting hardware. Aunt Flow recommends that the dispenser be installed by a qualified, professional contractor.
- The dispenser's internal parts present pinch points that could cause finger or hand injuries unless avoided. Do not open the dispenser cabinet unless you have read and fully understand these instructions. To avoid injury, do not cause the internal gears or arms to operate or move while fingers or hands are near the moving parts.
- The dispenser roller inside the cabinet may create a pinch point. To avoid injury, do not insert fingers upwards into the dispenser cabinet at the opening where the product is dispensed. If the product is not dispensed, contact hello@goauntflow.com.
- When operating the dispenser, always press on the center of the dispenser button.
- Do not attempt to repair the dispenser. If the dispenser fails to work properly, contact hello@goauntflow.com.
- Only use the dispenser as designed and intended, reloading with only Aunt Flow® Tampons and Pads.
- Do not subject the dispenser to misuse, abnormal use, or abuse.
- Properly maintain the dispenser at all times.
- Do not modify or alter the dispenser in any way.
- Do not expose the dispenser to abnormal heat, water or other environmental conditions.





SCAN HERE

Installation Videos

Loading Videos

Download Guides

INSTALLATION GUIDE:

1. Inspect packaging, report any damage to the shipping company.
2. Unpack unit from packaging. Inspect the dispenser and record any damage. Included in the package are:
 - Dispenser with locking key
 - Installation Operations Manual with mounting template
 - Installation Kit with hardware

3. Locate on the wall where the dispenser will be mounted ensuring there is adequate clearance space.

ADA Guidelines

Access to the dispenser should be 40" to 48" above the floor to allow forward and side reach by anyone in a wheelchair. The dispenser can be operated by using only one hand by pushing in the push button. There is no need for tight grasping, pinching or twisting of the wrist.

4. Obtain the mounting template from the packaging.
5. Using the mounting template, position the top hole 61" to 73" from the floor. This will position the access point (buttons) at the ADA required 40" to 48" above the floor. Ensure the mounting template is even and level with the floor.
6. Mark the location of the 3 mounting holes shown on the template into the wall.
7. Drill 3 holes at the marked mounting location using a 3/16" drill bit. Note: If mounting to drywall, standard drill bits may be used. If mounting onto tile or cinder block wall, special drill bits may be required.
8. Determine which wall inserts are required, collect from the provided hardware bag:
 - i. *Drywall, Tile Wall:* Use RED inserts (Fig. 1)
 - ii. *Concrete, Cinder Block Wall:* Use GREEN inserts (Fig. 2)



Fig. 1



Fig. 2





SCAN HERE

Installation Videos

Loading Videos

Download Guides

9. Insert the 3 included mounting screws into the wall inserts and tighten until there is $\frac{1}{2}$ inch space from the wall.
10. Unlock the front door with the provided key, open front door.
11. Remove the lower panel by unscrewing the 2 screws in the top flange. Retain the screws for later use when the panel needs to be reassembled.
12. The panel is secured at the bottom with 2 standoffs and keyhole slots see Fig 3.



Fig. 3

13. The panel is slid up and off to remove it from the back cabinet, see Fig. 5.
14. Retain lower panel to be reinserted after the dispenser is mounted.



Fig. 5



**SCAN HERE**

Installation Videos
Loading Videos
Download Guides

15. With the cover open, align the 3 screws into the 3 keyhole slots in the back of the cabinet.
16. Tighten down all 3 screws so the dispenser is secured to the wall.
17. Reinstall the lower panel by engaging the standoff into the top of the keyhole slot and sliding down.
18. Reinstall the screws removed previously into the top flange of the lower panel to secure to the dispenser.
19. Close and lock the front cover.
20. Activate both buttons and ensure they fully return.
21. The dispenser is now ready to be loaded with Aunt Flow® Menstrual Applicator Tampons and Pad Cartridges.

FILLING + REFILLING WITH AUNT FLOW® APPLICATOR TAMPONS

1. With the front cover open, grab a handful of 4-6 tampons at a time.
2. Carefully drop each handful directly to the bottom of the hopper, **ensuring tampons lay flat.** Continue to load until there are 50 tampon tubes in the right column. Do not overfill the dispenser.
3. Test the dispenser by pushing the right button to ensure that product is dispensed and the button returns to the original position.
4. The dispensed product may be placed back in the dispenser.
5. Close the front cover and lock with the key provided.





SCAN HERE

Installation Videos

Loading Videos

Download Guides

FILLING + REFILLING WITH AUNT FLOW® MENSTRUAL PAD CARTRIDGES

1. Open the front door by using the key provided to unlock.
2. Aunt Flow® Menstrual Pad Cartridges are loaded on the left side of the dispenser (50 pads).
The Aunt Flow® Menstrual Pad Cartridges are shipped in a bundle of 10 units with a banding strip securing the bundle.
3. With the banding strip still attached, slide the entire bundle into the column. **Ensure the Aunt Flow logo is facing up AND away (See Step One, Right)**
4. Guide the Aunt Flow® Menstrual Pad Cartridge down the hopper.
5. With your fingers, tear away the front piece of the banding strip from the bottom and pull it away so the pads are freely allowed to slide through the column. Do NOT pull the banding strip away from the top.
6. Repeat steps 2-5 until the column is full.
7. Test the dispenser by pushing the left button to ensure that product is dispensed and the button returns to the original position. The pad envelope will stick out the slot in the dispenser and may be removed by pulling out.
8. NOTE: You know the pad is loaded correctly if the pad dispenses with the Aunt Flow logo on the top.
9. The dispensed product may be placed back in the dispenser.
10. Close the front cover and lock with the key provided.

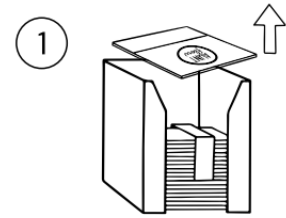

Place envelope side up and logo towards front

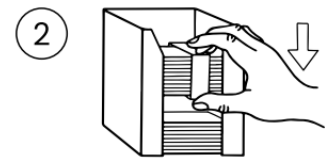

Guide pad cartridge

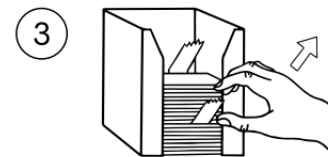

Tear cartridge paper and remove from the bottom



NEED MORE PRODUCT?

Contact: hello@goauntflow.com / 562-320-8250

Order at goauntflow.com



Copyright Aunt Flow 2022 - Patent Pending Dispenser + Product, ALL RIGHTS RESERVED

Questions + Additional Languages: hello@goauntflow.com / 562-320-8250